

**MORRIS & PARTNERS** Architects

NOTES. Work: 1 SEARLE STREET, CAMBRIDGE Client: DR A AND MRS. L HIBBE  
Reference No.: BC105. Notes made by: RM. Date: 4.10.2011 Sheet No.: 105.1.

Description of notes: KEY LOCATION PLAN

SCALE: 1:1250

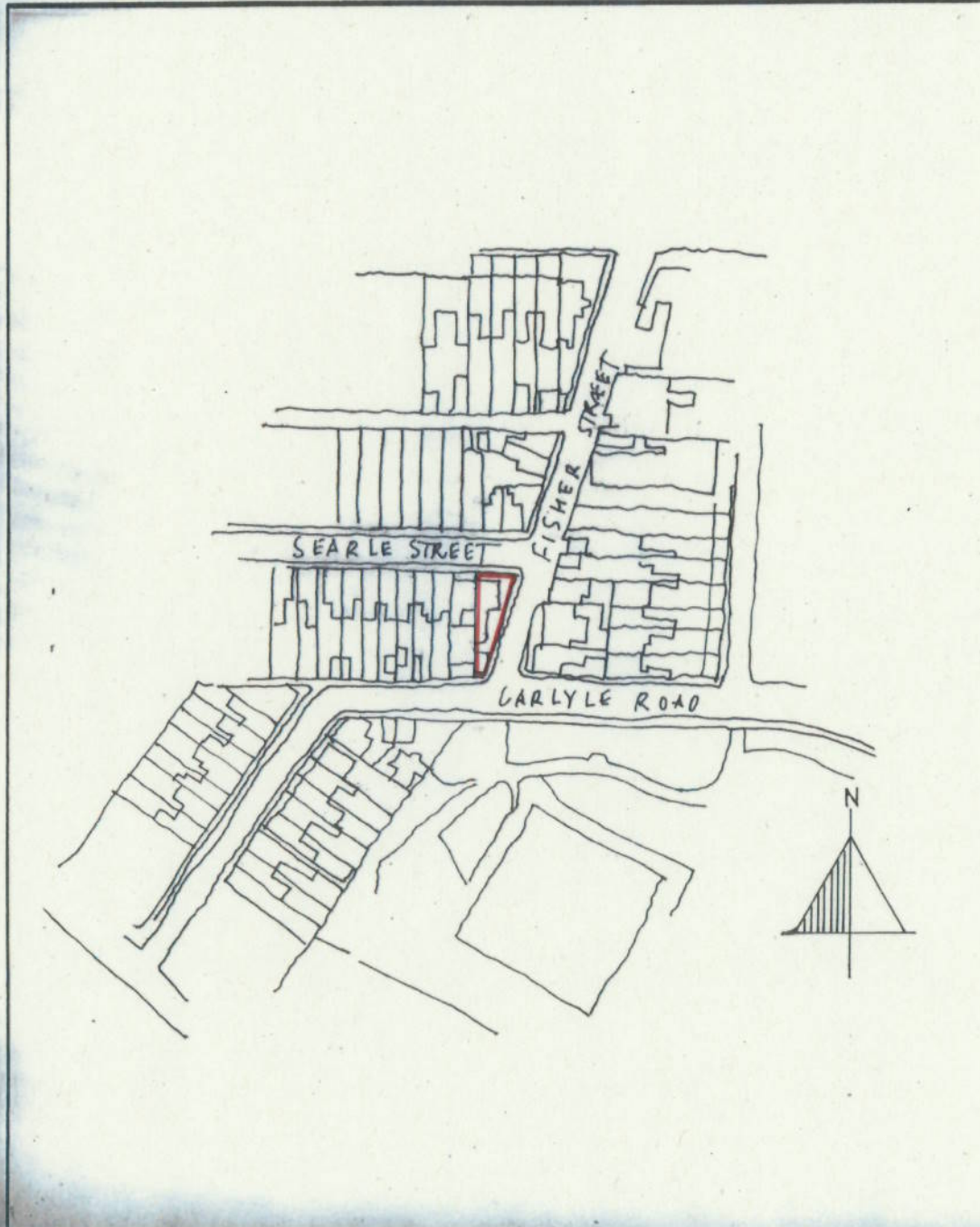



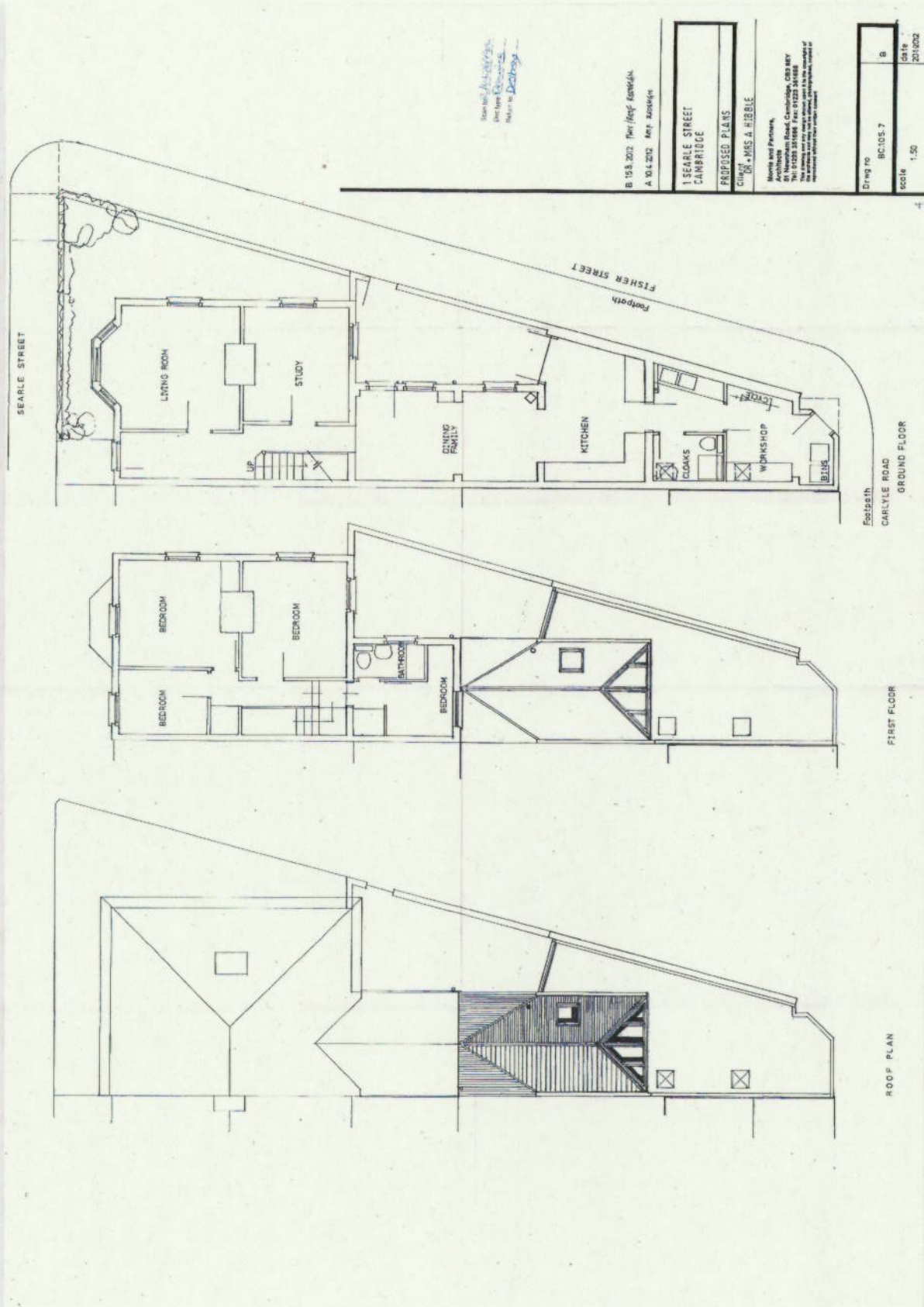

Steven J. J. Architects  
 Directors: Steven J. J. Architects  
 Reliance on Design

B 158, 202 Plan Regd. KENNEDY  
 A 101, 202 Reg. Zoning

1 SEARLE STREET  
 CAMBRIDGE

PROPOSED PLANS

CLIENT: DR. & MRS. A. HERBLE

Heads of Partners,  
 Architects  
 21 Newmarket Road, Cambridge, CB5 8BY  
 Tel: 01223 353900  
 The drawings and any other documents submitted to the Council are the property of Steven J. J. Architects and shall remain the property of Steven J. J. Architects.

Drawn by:	BC105.7	B	15/11/2002
Scale:	1:50		

Footpath  
 CARLYLE ROAD  
 GROUND FLOOR

FIRST FLOOR

ROOF PLAN